

Three bedroom home

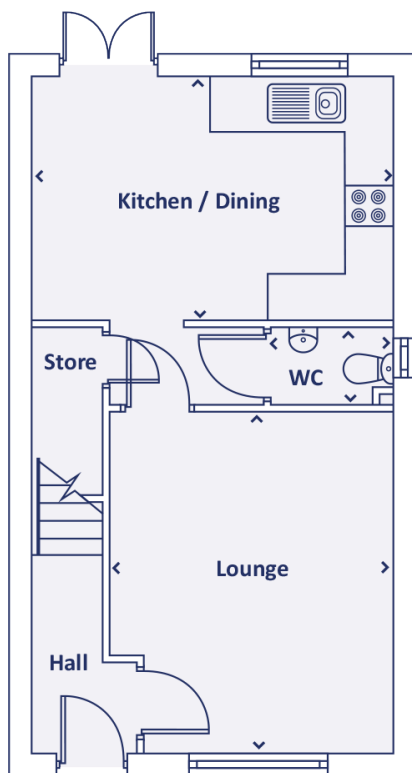

**The Leathley**  
at Canterbury Park



## Ground floor

Kitchen / Dining room	3.04m x 4.48m   10'0" x 14'7"
Living room	4.26m x 3.55m   14'0" x 11'6"
WC	1.51m x 0.96m   5'0" x 3'1"

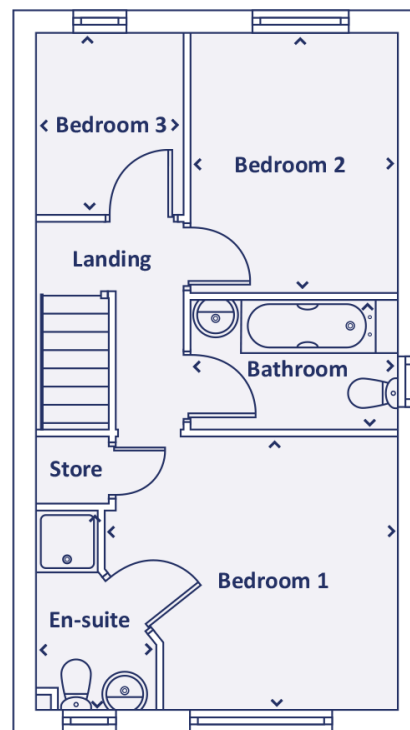

## First floor

Master Bedroom	3.39m x 3.65m   11'1" x 12'0"
Bedroom 2	3.21m x 2.59m   10'5" x 8'5"
Bedroom 3	2.24m x 1.82m   7'3" x 6'0"
Bathroom	1.61m x 2.59m   5'4" x 8'5"
En-suite	2.47m x 1.49m   8'1" x 4'9"

 0151 290 7000

 [marketing@livvhomes.com](mailto:marketing@livvhomes.com)

 [livvhomes.com](https://www.livvhomes.com)



Computer generated images and floor plans are for illustrative purposes only. They depict a typical layout and style of the individual plot, and do not constitute a contract, part of a contract or warranty. Features and finishes vary from plot to plot. For exact plot specifications please contact our sales team. All dimensions are approximate and you should undertake your own measurements before ordering any flooring, fixtures, fittings or furniture.

**Livv**  
homes