



Three bedroom home



The Kellington

at Canterbury Park



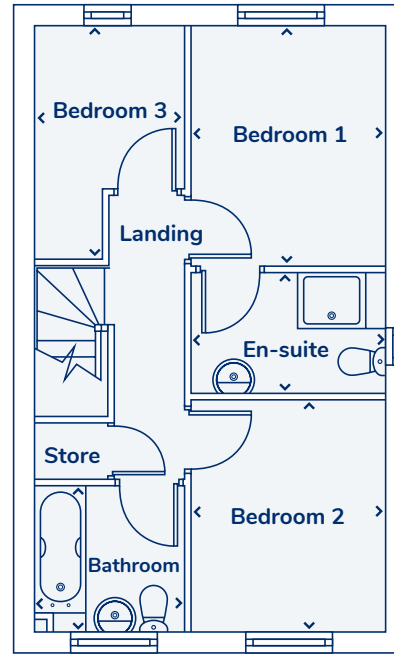
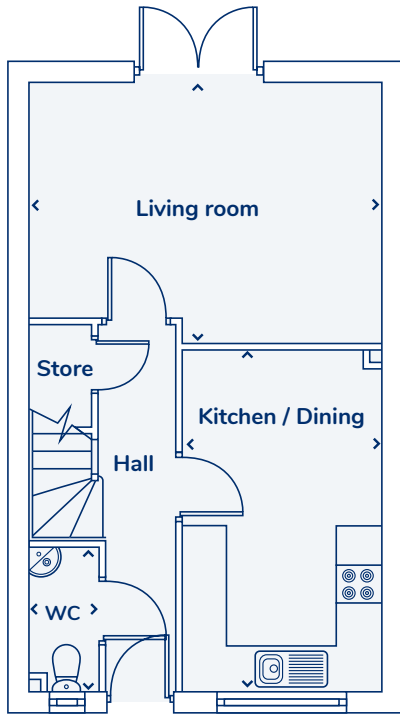

Ground floor

Kitchen / Dining room	4.61m x 2.67m 15'1" x 8'7"
Living room	3.52m x 4.72m 11'5" x 15'5"
WC	1.94m x 0.90m 6'4" x 2'9"

First floor

Master Bedroom	3.29m x 2.60m 10'8" x 8'5"
Bedroom 2	3.10m x 2.20m 10'2" x 8'5"
Bedroom 3	3.18m x 2.03m 10'4" x 6'6"
Bathroom	1.94m x 2.03m 6'4" x 6'6"
En-suite	1.64m x 2.60m 5'4" x 8'6"

 0151 290 7891

 info@livvhomes.com

 [livvhomes.com](https://www.livvhomes.com)



Computer generated images and floor plans are for illustrative purposes only. They depict a typical layout and style of the individual plot, and do not constitute a contract, part of a contract or warranty. Features and finishes vary from plot to plot. For exact plot specifications please contact our sales team. All dimensions are approximate and you should undertake your own measurements before ordering any flooring, fixtures, fittings or furniture.

