

Four bedroom home

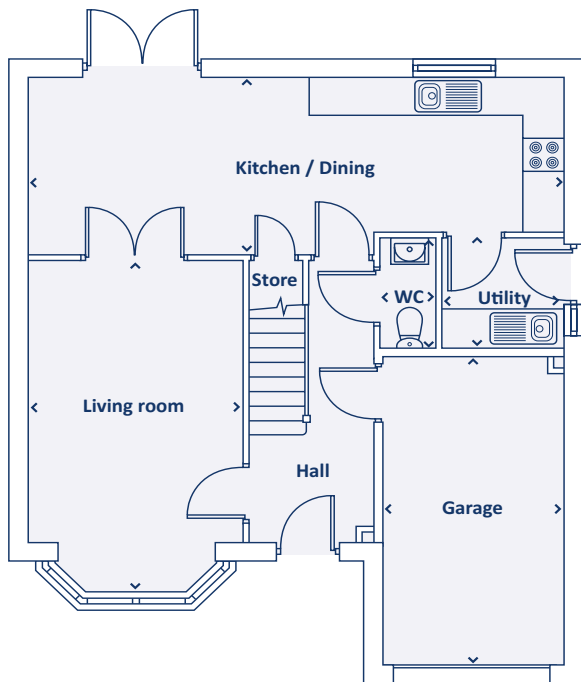

The Patrington

at Canterbury Park



Ground floor

Kitchen / Dining room	7.89m x 2.79m 25'9" x 9'1"
Living room	5.11m x 3.17m 16'8" x 10'4"
W.C.	1.69m x 0.82m 5'5" x 2'7"
Utility	1.77m x 1.69m 5'8" x 5'5"

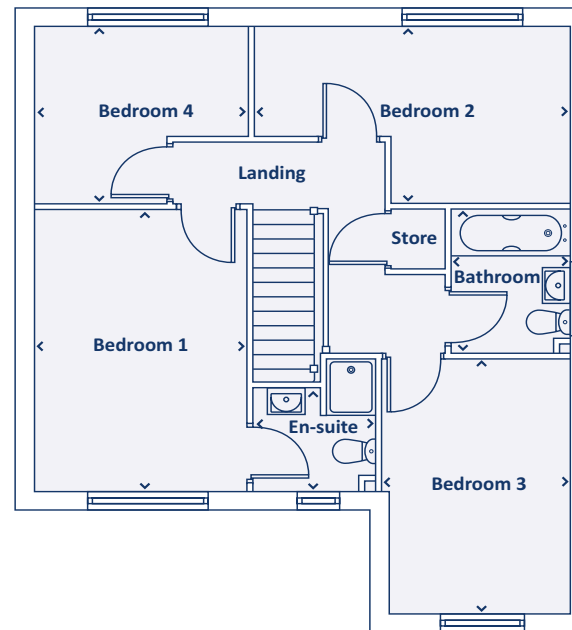

First floor

Bedroom 1	4.35m x 3.17m 14'3" x 10'4"
Bedroom 2	4.62m x 2.77m 15'2" x 9'1"
Bedroom 3	4.71m x 2.75m 15'5" x 9'0"
Bedroom 4	3.17m x 2.77m 10'4" x 9'1"
Bathroom	2.23m x 1.71m 7'3" x 5'6"
En-suite	1.78m x 1.56m 5'8" x 5'1"

 0151 290 7891

 info@livvhomes.com

 [livvhomes.com](https://www.livvhomes.com)



Computer generated images and floor plans are for illustrative purposes only. They depict a typical layout and style of the individual plot, and do not constitute a contract, part of a contract or warranty. Features and finishes vary from plot to plot. For exact plot specifications please contact our sales team. All dimensions are approximate and you should undertake your own measurements before ordering any flooring, fixtures, fittings or furniture.

Livv
homes