

Three bedroom home

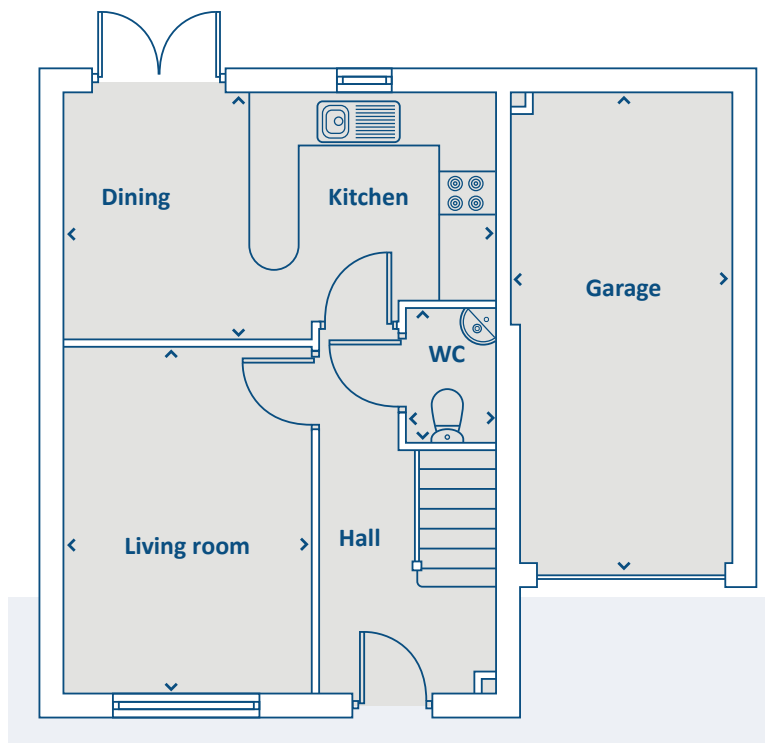

The Laytham
at Centerbury Park



Ground floor

Kitchen / Dining room	5.13m x 2.93m 16'10" x 9'8"
Living room	4.12m x 2.99m 13'6" x 9'10"
WC	1.60m x 1.04m 5'3" x 3'5"

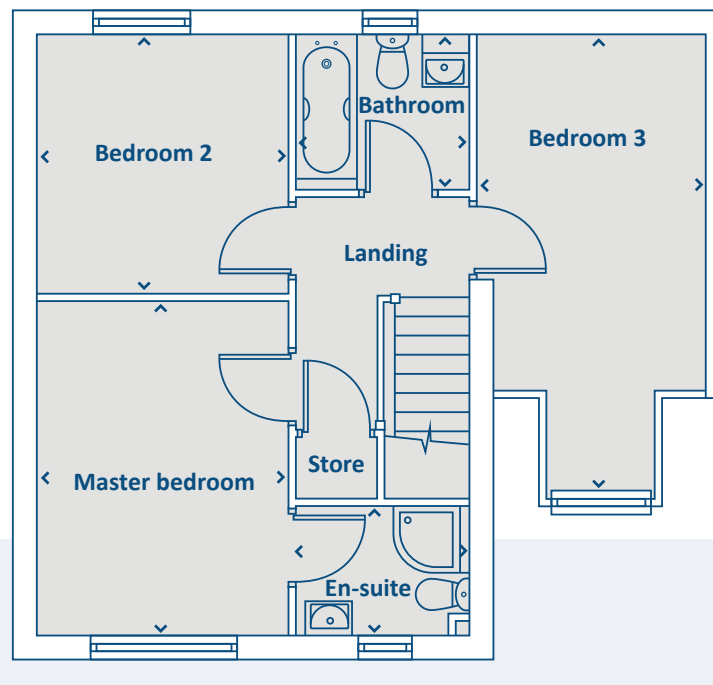

First floor

Master Bedroom	3.93m x 2.99m 12'11" x 9'10"
Bedroom 2	3.12m x 2.99m 10'3" x 9'10"
Bedroom 3	5.57m x 2.78m 18'3" x 9'1"
Bathroom	2.06m x 1.86m 6'9" x 6'1"
En-suite	2.08m x 1.50m 6'10" x 4'11"



0151 290 7891



info@livvhomes.com



livvhomes.com



Computer generated images and floor plans are for illustrative purposes only. They depict a typical layout and style of the individual plot, and do not constitute a contract, part of a contract or warranty. Features and finishes vary from plot to plot. For exact plot specifications please contact our sales team. All dimensions are approximate and you should undertake your own measurements before ordering any flooring, fixtures, fittings or furniture.

Livv
homes