

The Ellesmere

at Abbotsfield

3 bedroom home



Contact our team for
more information today

0151 290 7891

info@livvhomes.com

livvhomes.com

Livv
homes

The Ellesmere

at Abbotsfield

Ground floor

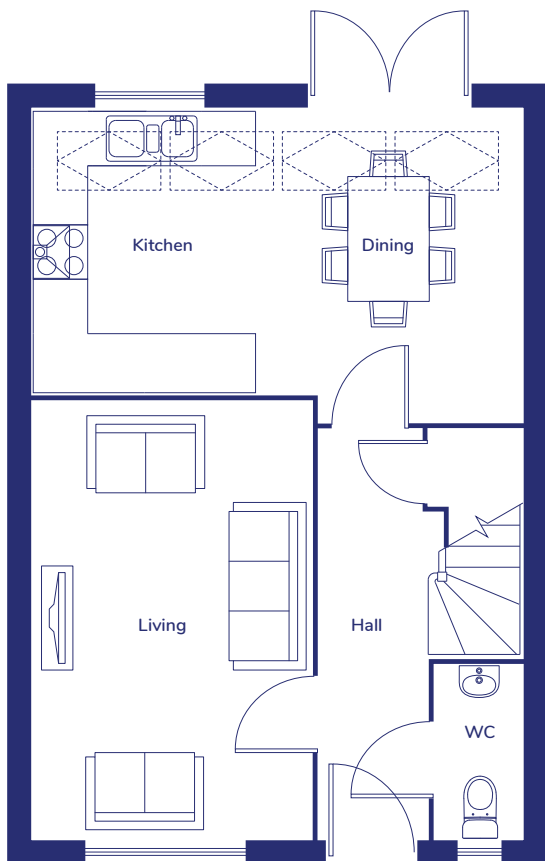

Kitchen / dining room	3.15m x 5.43m 10'4" x 17' 10"
Living room	4.84m x 3.10m 15'11" x 10'2"
W.C	1.93m x 1.00m 6'4" x 3'3"

First Floor

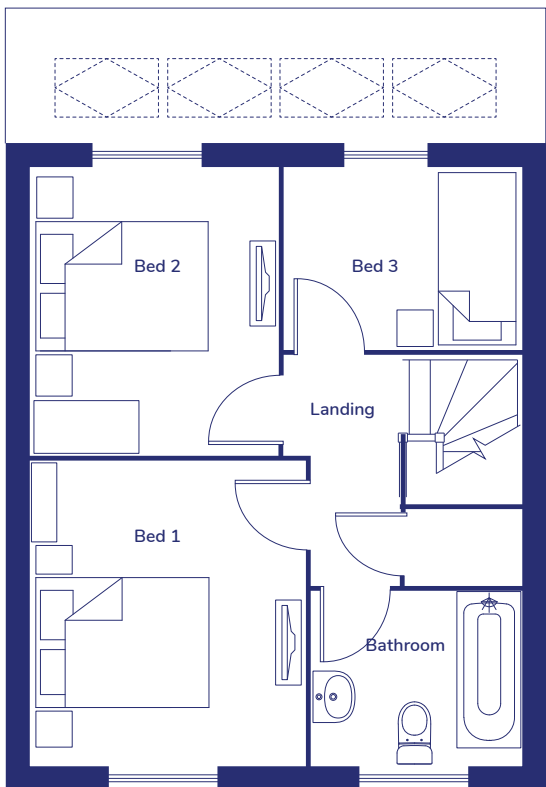

Bedroom 1	3.36m x 3.05m 11'0" x 10'0"
Bedroom 2	3.17m x 2.74m 10'5" x 9'0"
Bedroom 3	2.01m x 2.62m 6'7" x 8'7"
Bathroom	1.93m x 2.32m 6'4" x 7'7"



[livvhomes.com](https://www.livvhomes.com)

Computer generated images and floor plans are for illustrative purposes only. They depict a typical layout and style of the individual plot, and do not constitute a contract, part of a contract or warranty. Features and finishes vary from plot to plot. For exact plot specifications please contact our sales team. All dimensions are approximate and you should undertake your own measurements before ordering any flooring, fixtures, fittings or furniture.

