

The Weaver

at Abbotsfield

3 bedroom home



Contact our team for
more information today

☎ 0151 290 7891

✉ info@livvhomes.com

🏠 [livvhomes.com](https://www.livvhomes.com)

Livv
homes

The Weaver

at Abbotsfield



Ground floor

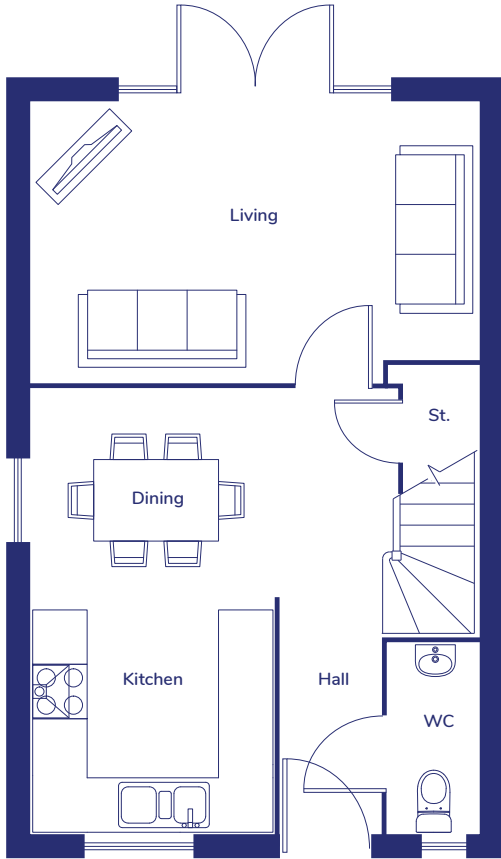

Kitchen / dining room 4.90m x 3.86m* | 16'1" x 12'8"*

Living room 3.09m x 4.93m | 10'2" x 16'2"

W.C 2.10m x 1.00m | 6'11" x 3'4"

First Floor

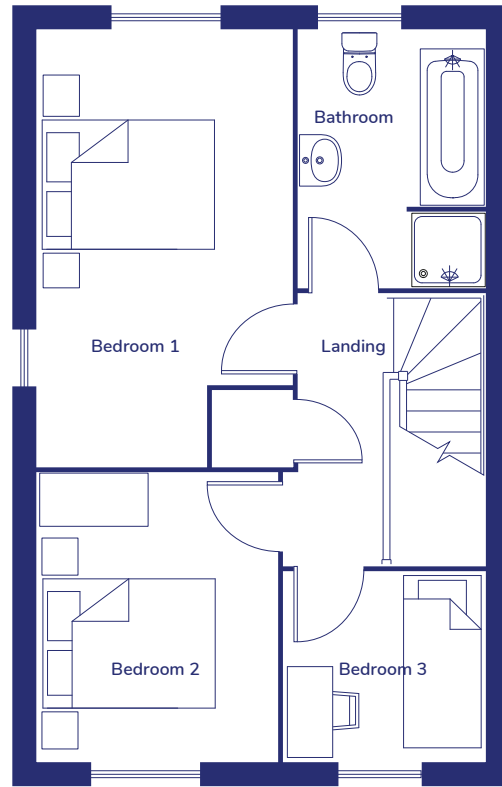

Bedroom 1 4.80m* x 2.80m* | 15'9"* x 9'2"*

Bedroom 2 3.19m x 2.65m | 10'6" x 8'8"

Bedroom 3 2.10m x 2.22m | 6'11" x 7'3"

Bathroom 2.84m x 2.06m | 9'4" x 6'9"

*to the widest point

livvhomes.com

Computer generated images and floor plans are for illustrative purposes only. They depict a typical layout and style of the individual plot, and do not constitute a contract, part of a contract or warranty. Features and finishes vary from plot to plot. For exact plot specifications please contact our sales team. All dimensions are approximate and you should undertake your own measurements before ordering any flooring, fixtures, fittings or furniture.

